

HENRY COUNTY HIGHWAY DEPARTMENT SITE PLAN PROPOSED STORAGE BUILDING

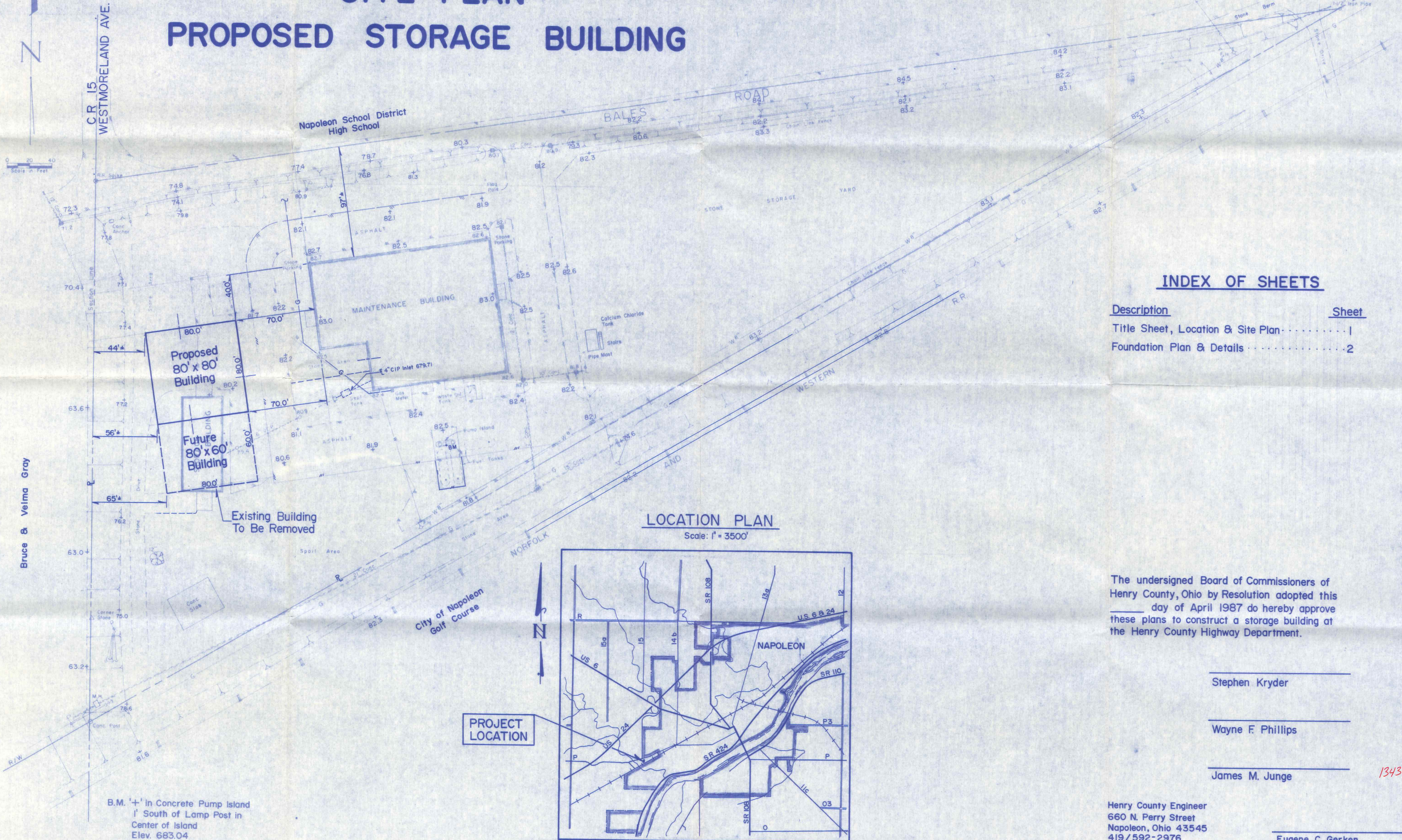

INDEX OF SHEETS

Description	Sheet
Title Sheet, Location & Site Plan	1
Foundation Plan & Details	2

LOCATION PLAN

Scale: 1" = 3500'

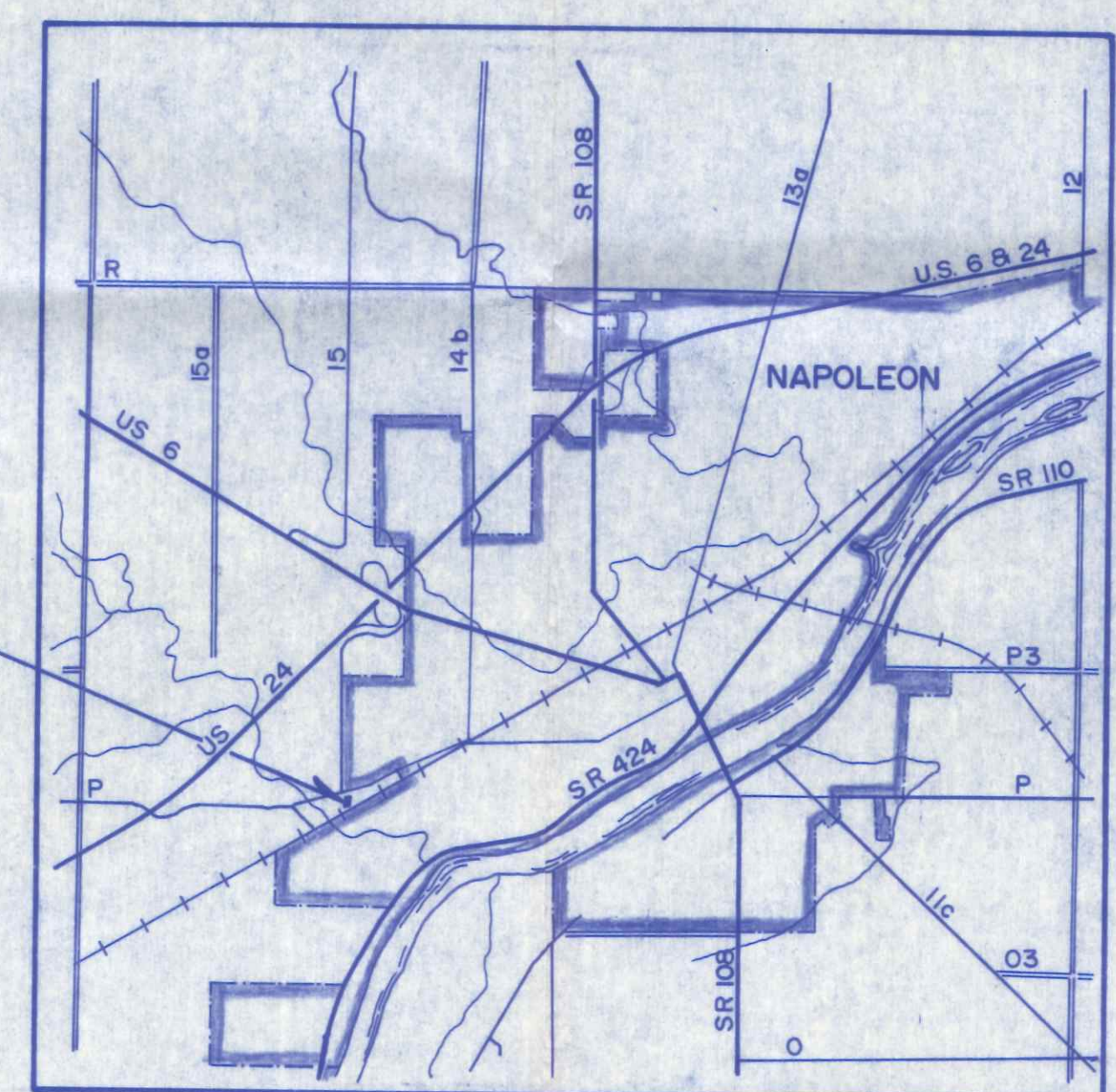

The undersigned Board of Commissioners of Henry County, Ohio by Resolution adopted this _____ day of April 1987 do hereby approve these plans to construct a storage building at the Henry County Highway Department.

Stephen Kryder

Wayne F. Phillips

James M. Junge

1343 Bales Rd

Henry County Engineer
660 N. Perry Street
Napoleon, Ohio 43545
419/592-2976

Eugene C. Gerken
Ohio Prof. Engineer #31410